

(4) 1/4" X 20 STAINLESS STEEL NYLOC  
NUTS & WASHERS FURNISHED BY  
AEP SPAN W/EACH BACKUP PLATE.

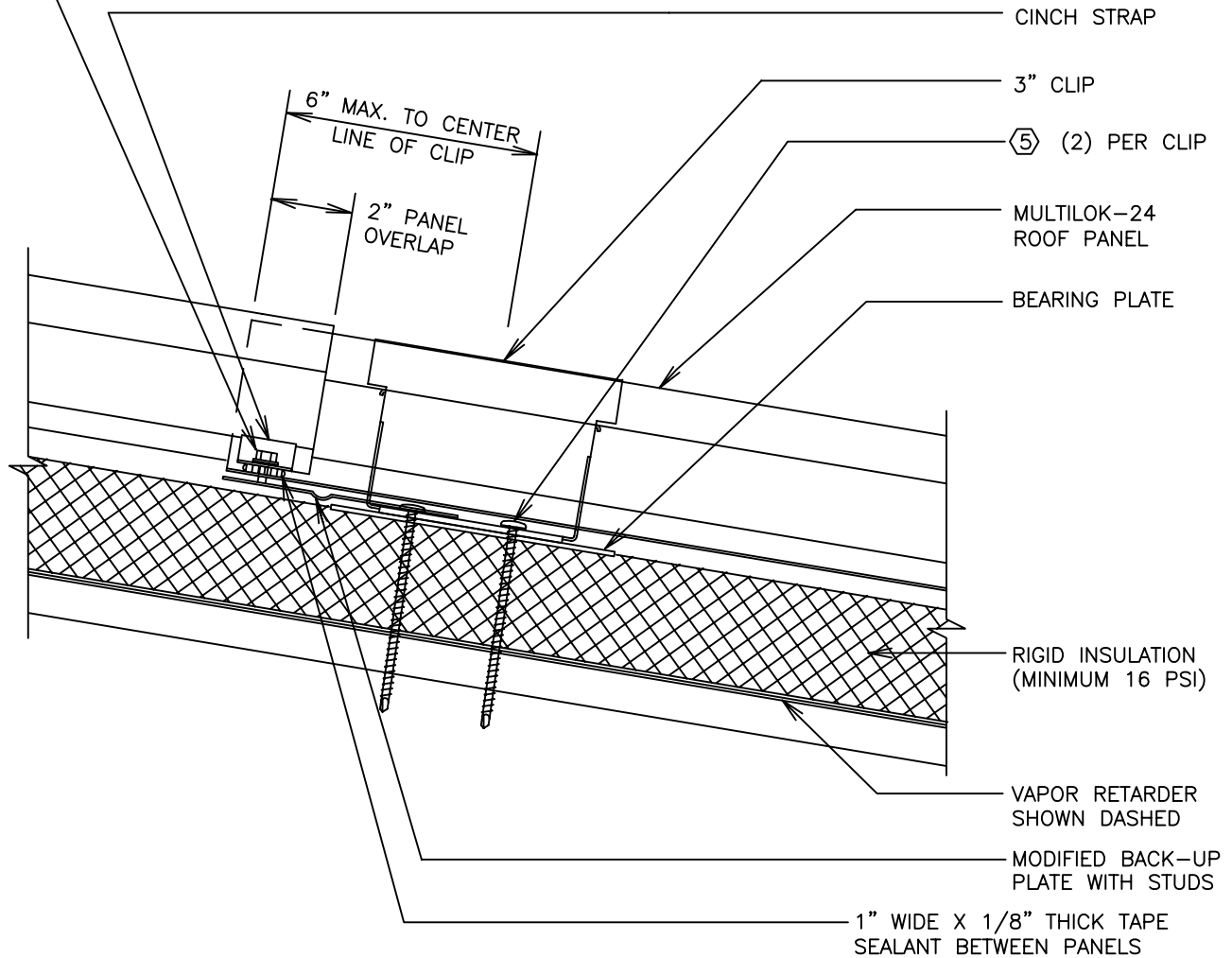

NOTES:

1. APPLICATION DIRECTLY OVER DECKING DOES NOT REQUIRE BEARING PLATE.



MULTILOK-24

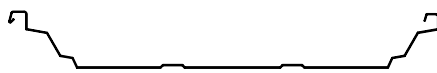

END LAP  
(OVER SOLID SUBSTRATE)

ML-05